

Nassau Street

I | II | 1 | 2 | 3 | 4 | 5 | 6 | 7 | 8 | 9 | 10 | 11 | 12 | 13 | 14 | 15 | 16 | 17 | 18 | 19 |

- Elevator
- Men
- Women
- Wheelchair access
- Emergency exit
- Campus Telephone
- Public Telephone
- Photocopier

Dark shading
indicates shelving
for oversized books

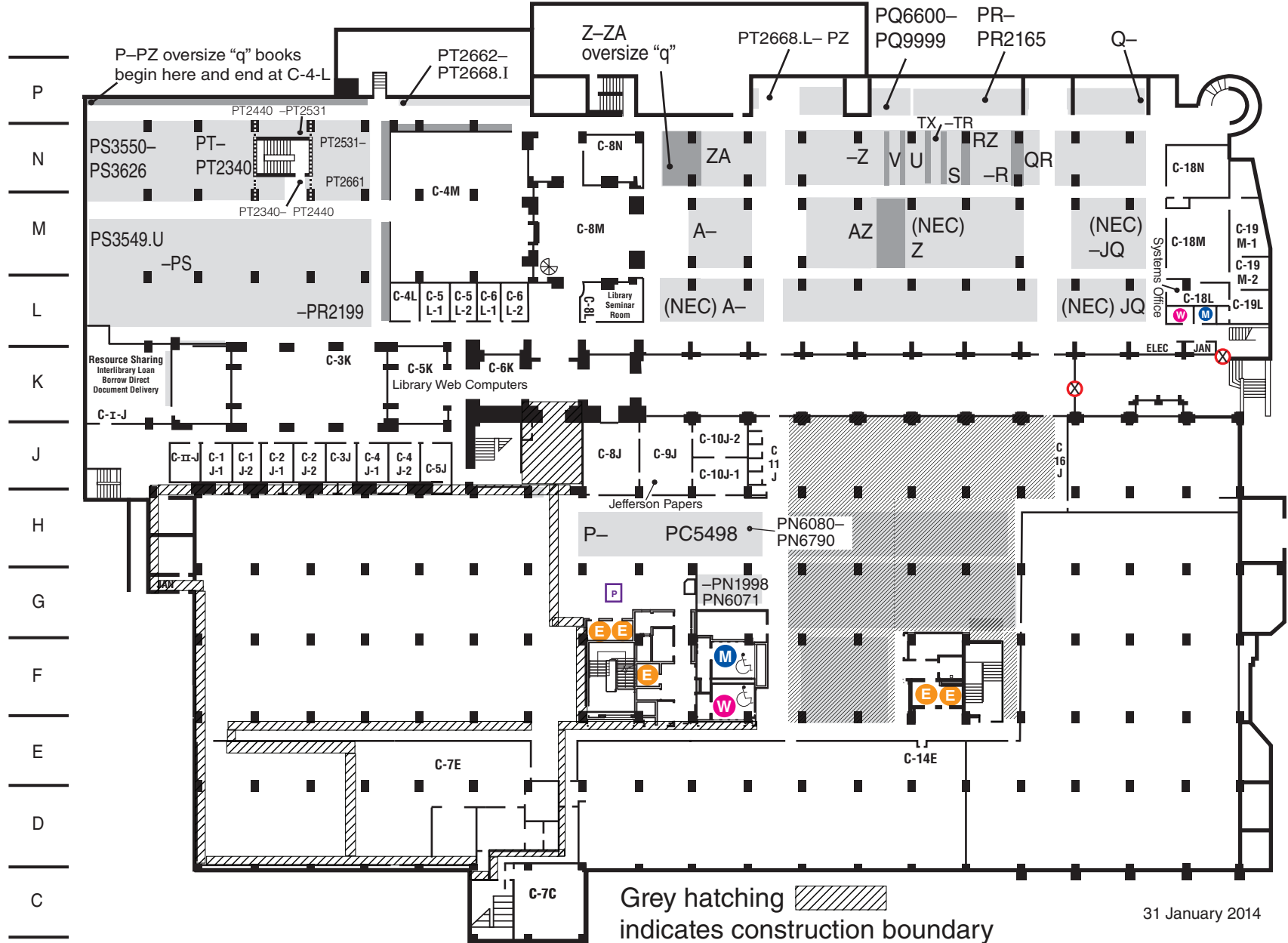

Grey hatching indicates construction boundary

31 January 2014